

**SCREENING REPORT FOR AN ENVIRONMENTAL AUTHORIZATION OR
FOR A PART TWO AMENDMENT OF AN ENVIRONMENTAL AUTHORISATION
AS REQUIRED BY THE 2014 EIA REGULATIONS – PROPOSED SITE
ENVIRONMENTAL SENSITIVITY**

EIA Reference number: Unknown

Project name: Erf 511, Wetton

Project title: Residential Development

Date screening report generated: 15/01/2021 13:45:28

Applicant: Eugene

Compiler: Eugene

Compiler signature:
.....

Application Category: Any activities within or close to a watercourse

Table of Contents

Proposed Project Location	3
Orientation map 1: General location	3
Map of proposed site and relevant area(s)	4
Cadastral details of the proposed site	4
Wind and Solar developments with an approved Environmental Authorisation or applications under consideration within 30 km of the proposed area	4
Environmental Management Frameworks relevant to the application	4
Environmental screening results and assessment outcomes	5
Relevant development incentives, restrictions, exclusions or prohibitions	5
Map indicating proposed development footprint within applicable development incentive, restriction, exclusion or prohibition zones	6
Proposed Development Area Environmental Sensitivity	6
Specialist assessments identified	7
Results of the environmental sensitivity of the proposed area	9
MAP OF RELATIVE AGRICULTURE THEME SENSITIVITY	9
MAP OF RELATIVE ANIMAL SPECIES THEME SENSITIVITY	10
MAP OF RELATIVE AQUATIC BIODIVERSITY THEME SENSITIVITY	11
MAP OF RELATIVE CIVIL AVIATION THEME SENSITIVITY	12
MAP OF RELATIVE DEFENCE THEME SENSITIVITY	13
MAP OF RELATIVE PALEONTOLOGY THEME SENSITIVITY	14
MAP OF RELATIVE PLANT SPECIES THEME SENSITIVITY	15
MAP OF RELATIVE TERRESTRIAL BIODIVERSITY THEME SENSITIVITY	18

Proposed Project Location

Orientation map 1: General location

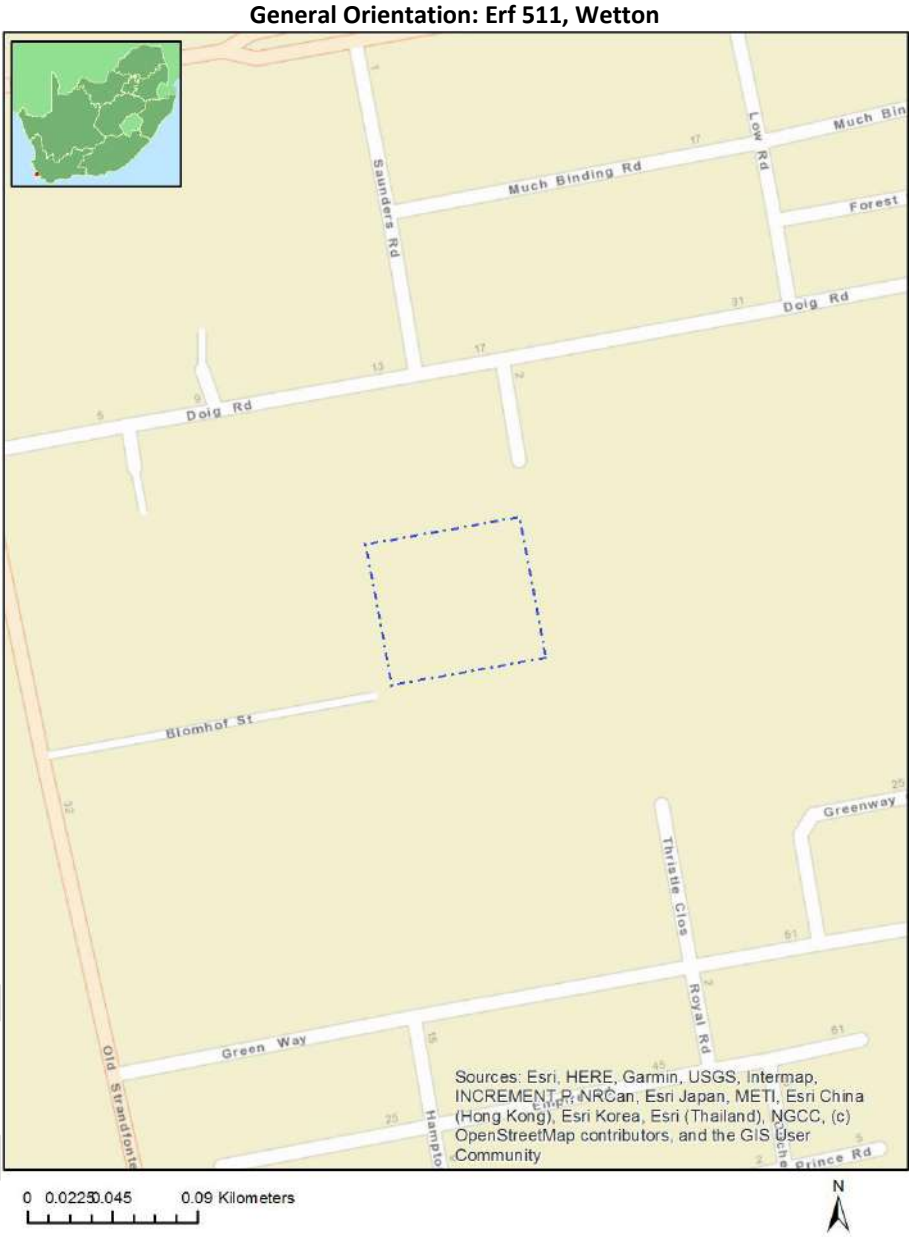

Map of proposed site and relevant area(s)

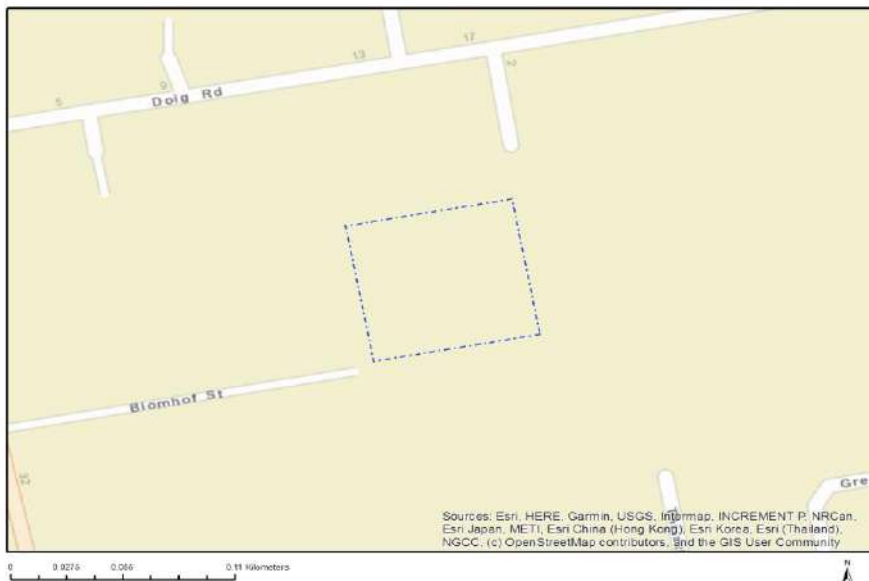

Cadastral details of the proposed site

Property details:

No	Farm Name	Farm/ Erf No	Portion	Latitude	Longitude	Property Type
1	WETTON	511	0	34°0'17.07S	18°31'5.52E	Erven

Development footprint¹ vertices:
No development footprint(s) specified.

Wind and Solar developments with an approved Environmental Authorisation or applications under consideration within 30 km of the proposed area

No nearby wind or solar developments found.

Environmental Management Frameworks relevant to the application

No intersections with EMF areas found.

¹ "development footprint", means the area within the site on which the development will take place and includes all ancillary developments for example roads, power lines, boundary walls, paving etc. which require vegetation clearance or which will be disturbed and for which the application has been submitted.

Environmental screening results and assessment outcomes

The following sections contain a summary of any development incentives, restrictions, exclusions or prohibitions that apply to the proposed development site as well as the most environmental sensitive features on the site based on the site sensitivity screening results for the application classification that was selected. The application classification selected for this report is:

Any activities within or close to a watercourse.

Relevant development incentives, restrictions, exclusions or prohibitions

The following development incentives, restrictions, exclusions or prohibitions and their implications that apply to this site are indicated below.

Incentive, restriction or prohibition	Implication
Strategic Transmission Corridor-Central corridor	https://screening.environment.gov.za/ScreeningDownloads/DevelopmentZones/GN11316February2018.pdf

Map indicating proposed development footprint within applicable development incentive, restriction, exclusion or prohibition zones

Project Location: Erf 511, Wetton



Proposed Development Area Environmental Sensitivity

The following summary of the development site environmental sensitivities is identified. Only the highest environmental sensitivity is indicated. The footprint environmental sensitivities for the proposed development footprint as identified, are indicative only and must be verified on site by a suitably qualified person before the specialist assessments identified below can be confirmed.

Theme	Very High sensitivity	High sensitivity	Medium sensitivity	Low sensitivity
Agriculture Theme		X		
Animal Species Theme			X	

Aquatic Biodiversity Theme	X			
Civil Aviation Theme		X		
Defence Theme			X	
Paleontology Theme				X
Plant Species Theme			X	
Terrestrial Biodiversity Theme	X			

Specialist assessments identified

Based on the selected classification, and the environmental sensitivities of the proposed development footprint, the following list of specialist assessments have been identified for inclusion in the assessment report. It is the responsibility of the EAP to confirm this list and to motivate in the assessment report, the reason for not including any of the identified specialist study including the provision of photographic evidence of the site situation.

N o	Specialist assessment	Assessment Protocol
1	Landscape/Visual Impact Assessment	https://screening.environment.gov.za/ScreeningDownloads/AssessmentProtocols/Gazetted_General_Requirement_Assessment_Protocols.pdf
2	Archaeological and Cultural Heritage Impact Assessment	https://screening.environment.gov.za/ScreeningDownloads/AssessmentProtocols/Gazetted_General_Requirement_Assessment_Protocols.pdf
3	Palaeontology Impact Assessment	https://screening.environment.gov.za/ScreeningDownloads/AssessmentProtocols/Gazetted_General_Requirement_Assessment_Protocols.pdf
4	Terrestrial Biodiversity Impact Assessment	https://screening.environment.gov.za/ScreeningDownloads/AssessmentProtocols/Gazetted_Terrestrial_Biodiversity_Assessment_Protocols.pdf
5	Aquatic Biodiversity Impact Assessment	https://screening.environment.gov.za/ScreeningDownloads/AssessmentProtocols/Gazetted_Aquatic_Biodiversity_Assessment_Protocols.pdf
6	Hydrology Assessment	https://screening.environment.gov.za/ScreeningDownloads/AssessmentProtocols/Gazetted_General_Requirement_Assessment_Protocols.pdf
7	Socio-Economic	https://screening.environment.gov.za/ScreeningDownloads/AssessmentProtocols/Gazetted_General_Requirement_Assessment_Protocols.pdf

	Assessment	
8	Plant Species Assessment	https://screening.environment.gov.za/ScreeningDownloads/AssessmentProtocols/Gazetted_Plant_Species_Assessment_Protocols.pdf
9	Animal Species Assessment	https://screening.environment.gov.za/ScreeningDownloads/AssessmentProtocols/Gazetted_Animal_Species_Assessment_Protocols.pdf

OFFICIAL

Results of the environmental sensitivity of the proposed area.

The following section represents the results of the screening for environmental sensitivity of the proposed site for relevant environmental themes associated with the project classification. It is the duty of the EAP to ensure that the environmental themes provided by the screening tool are comprehensive and complete for the project. Refer to the disclaimer.

MAP OF RELATIVE AGRICULTURE THEME SENSITIVITY

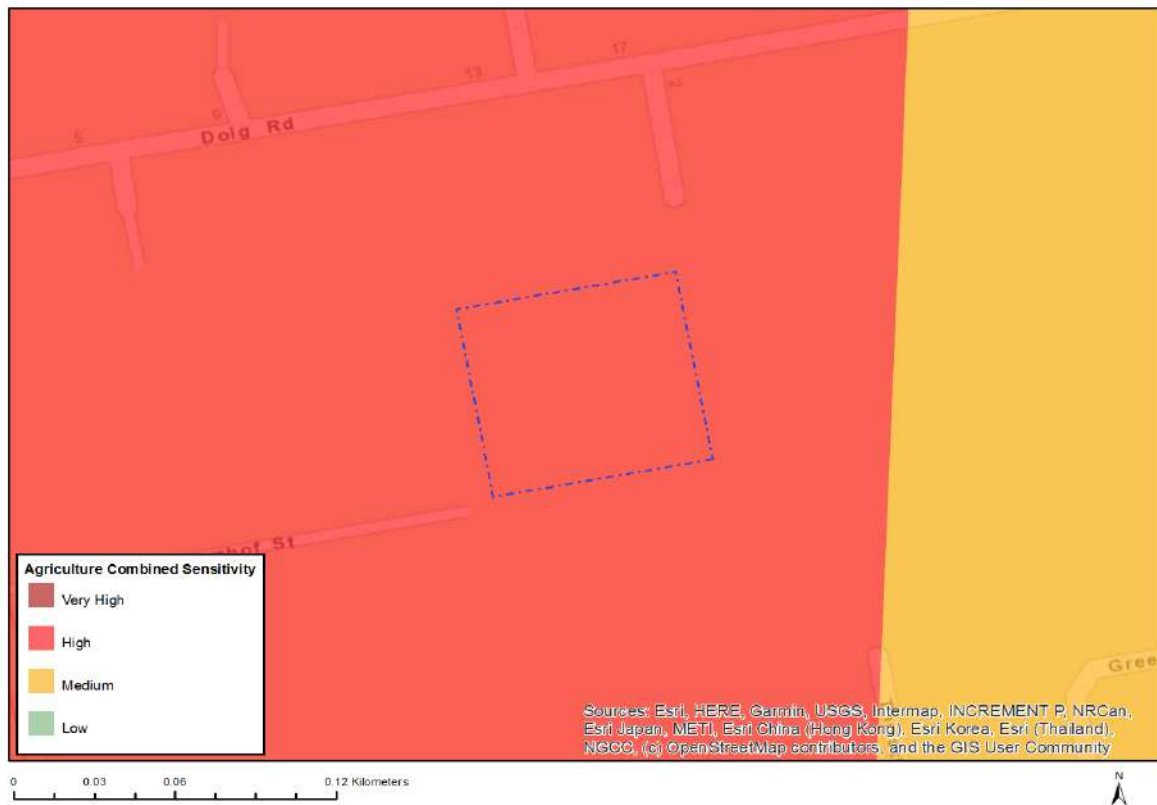

Very High sensitivity	High sensitivity	Medium sensitivity	Low sensitivity
	X		

Sensitivity Features:

Sensitivity	Feature(s)
High	Land capability;09. Moderate-High/10. Moderate-High

MAP OF RELATIVE ANIMAL SPECIES THEME SENSITIVITY

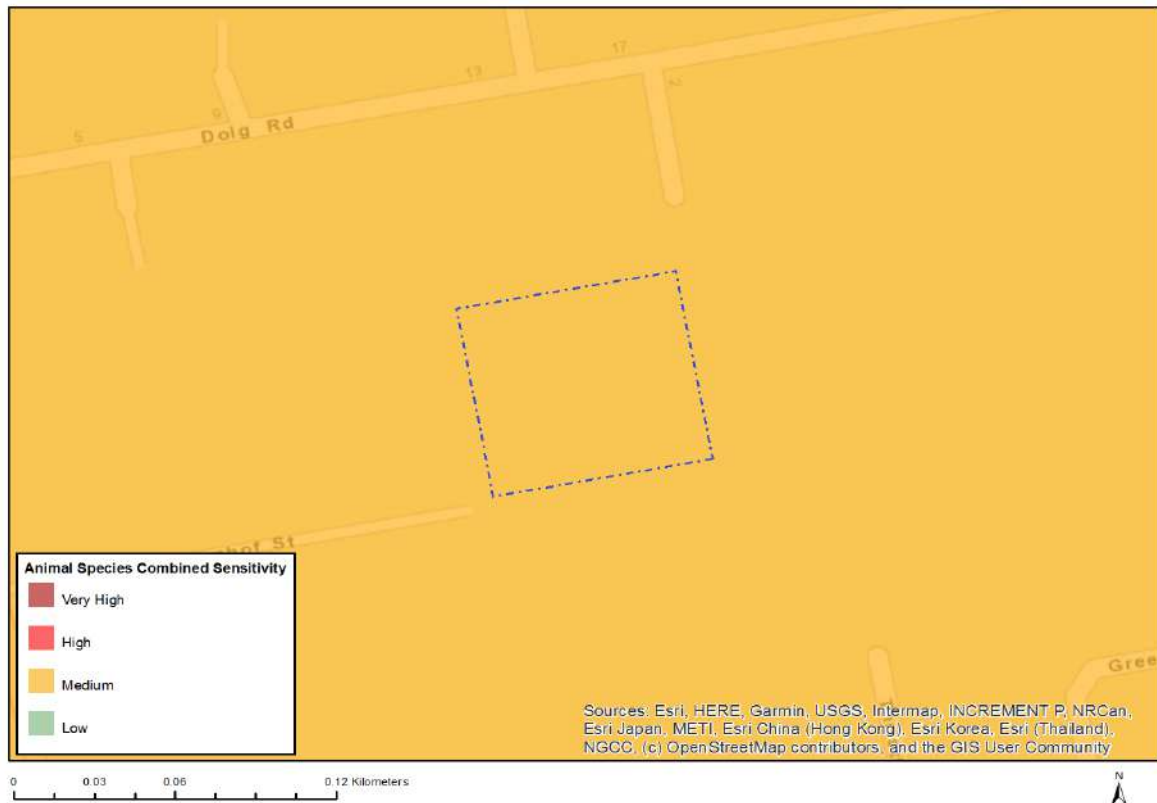

Where only a sensitive plant unique number or sensitive animal unique number is provided in the screening report and an assessment is required, the environmental assessment practitioner (EAP) or specialist is required to email SANBI at eiadatarequests@sanbi.org.za listing all sensitive species with their unique identifiers for which information is required. The name has been withheld as the species may be prone to illegal harvesting and must be protected. SANBI will release the actual species name after the details of the EAP or specialist have been documented.

Very High sensitivity	High sensitivity	Medium sensitivity	Low sensitivity
		X	

Sensitivity Features:

Sensitivity	Feature(s)
Medium	Invertebrate-Conocephalus peringueyi
Medium	Amphibia-Sclerophrys pantherina
Medium	Amphibia-Microbatrachella capensis

MAP OF RELATIVE AQUATIC BIODIVERSITY THEME SENSITIVITY



Very High sensitivity	High sensitivity	Medium sensitivity	Low sensitivity
X			

Sensitivity Features:

Sensitivity	Feature(s)
Very High	Strategic water source area

MAP OF RELATIVE CIVIL AVIATION THEME SENSITIVITY



Very High sensitivity	High sensitivity	Medium sensitivity	Low sensitivity
	X		

Sensitivity Features:

Sensitivity	Feature(s)
High	Within 15 km of a civil aviation radar
High	Between 8 and 15 km from a major civil aviation aerodrome

MAP OF RELATIVE DEFENCE THEME SENSITIVITY

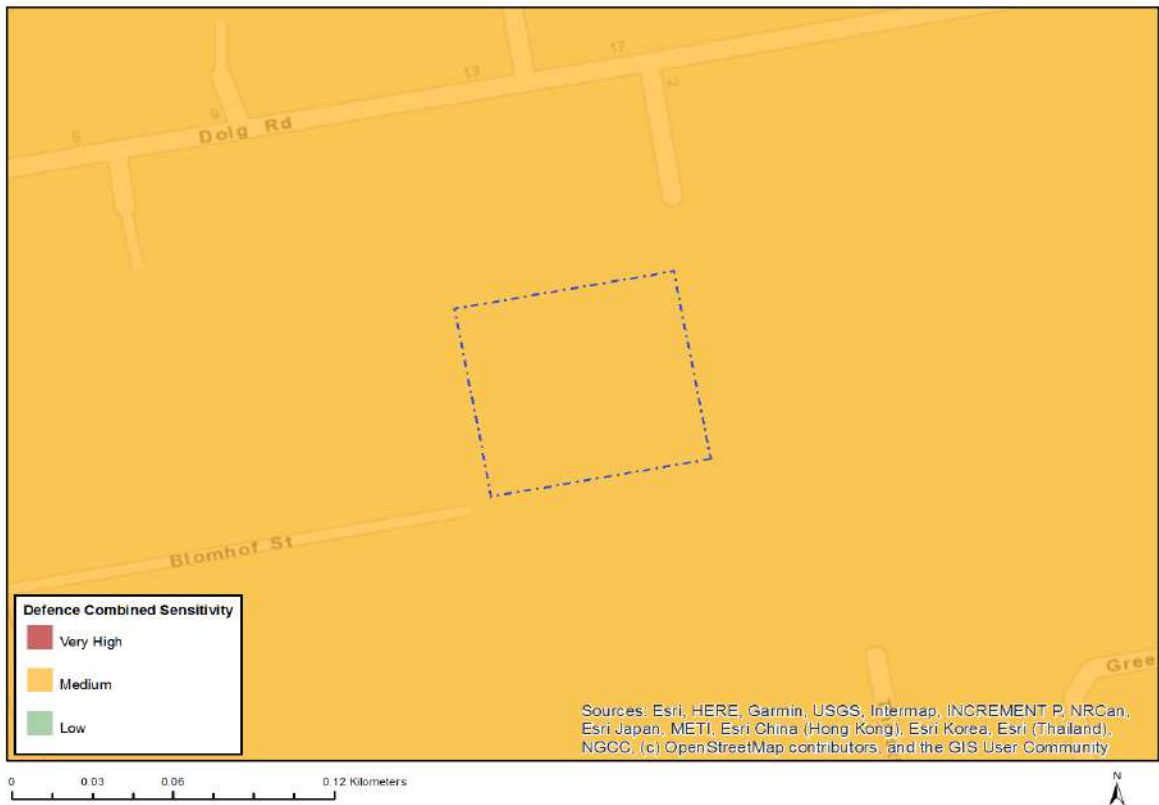

Very High sensitivity	High sensitivity	Medium sensitivity	Low sensitivity
		X	

Sensitivity Features:

Sensitivity	Feature(s)
Medium	Defence Site

MAP OF RELATIVE PALEONTOLOGY THEME SENSITIVITY



Very High sensitivity	High sensitivity	Medium sensitivity	Low sensitivity
			X

Sensitivity Features:

Sensitivity	Feature(s)
Low	Features with a Low paleontological sensitivity

MAP OF RELATIVE PLANT SPECIES THEME SENSITIVITY

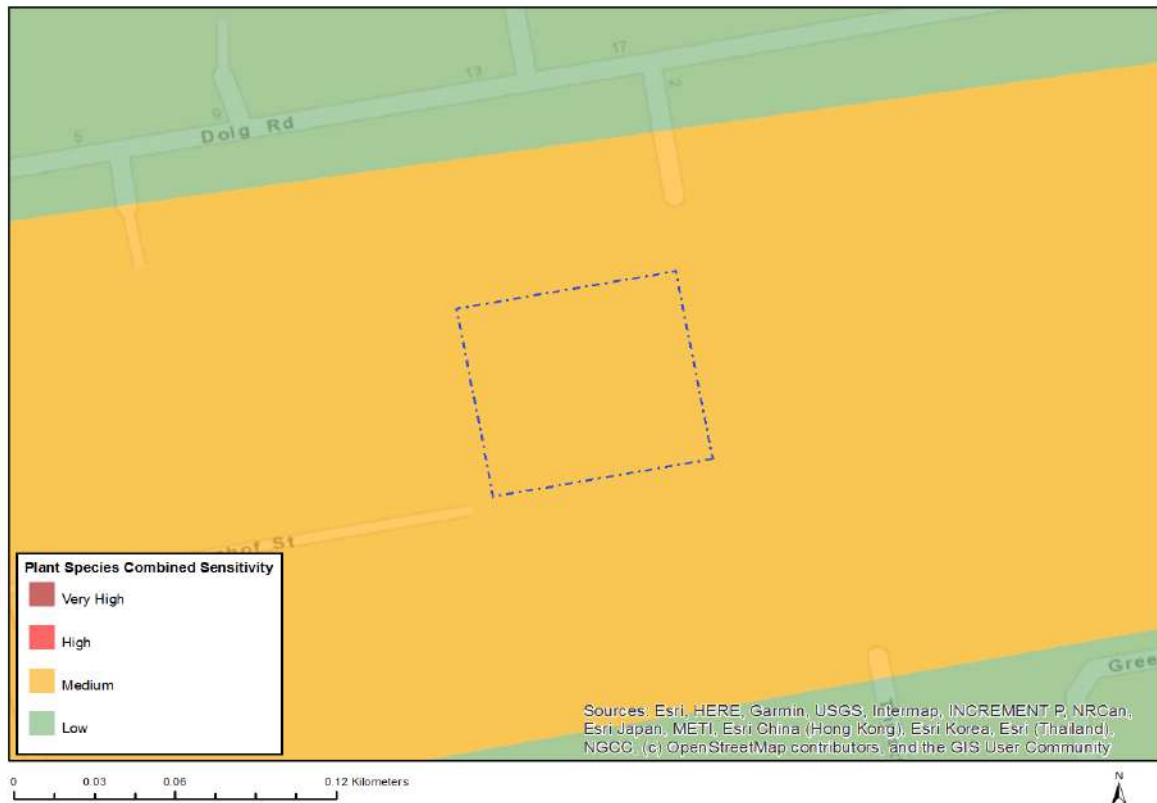

Where only a sensitive plant unique number or sensitive animal unique number is provided in the screening report and an assessment is required, the environmental assessment practitioner (EAP) or specialist is required to email SANBI at eiadatarequests@sanbi.org.za listing all sensitive species with their unique identifiers for which information is required. The name has been withheld as the species may be prone to illegal harvesting and must be protected. SANBI will release the actual species name after the details of the EAP or specialist have been documented.

Very High sensitivity	High sensitivity	Medium sensitivity	Low sensitivity
		X	

Sensitivity Features:

Sensitivity	Feature(s)
Medium	Lampranthus filicaulis
Medium	Lampranthus leptaleon
Medium	Lampranthus scaber
Medium	Lampranthus spiniformis
Medium	Lampranthus stenopetalus
Medium	Lampranthus stenus
Medium	Lampranthus tenuifolius
Medium	Antimima aristulata
Medium	Cleretum clavatum
Medium	Ruschia geminiflora
Medium	Lessertia argentea
Medium	Psoralea glaucina
Medium	Liparia splendens subsp. splendens
Medium	Aspalathus globulosa
Medium	Aspalathus lotoides subsp. lotoides

Medium	<i>Aspalathus retroflexa</i> subsp. <i>bicolor</i>
Medium	<i>Rafnia angulata</i> subsp. <i>humilis</i>
Medium	<i>Lebeckia plukenetiana</i>
Medium	<i>Podalyria argentea</i>
Medium	<i>Podalyria sericea</i>
Medium	<i>Thesium ecklonianum</i>
Medium	<i>Leucadendron cinereum</i>
Medium	<i>Leucadendron floridum</i>
Medium	<i>Leucadendron levisanus</i>
Medium	<i>Leucadendron linifolium</i>
Medium	<i>Leucospermum hypophyllocarpodendron</i> subsp. <i>hypophyllocarpodendron</i>
Medium	<i>Protea burchellii</i>
Medium	<i>Diastella proteoides</i>
Medium	<i>Serruria aemula</i>
Medium	<i>Serruria cyanoides</i>
Medium	<i>Serruria glomerata</i>
Medium	<i>Serruria trilopha</i>
Medium	<i>Microdon capitatus</i>
Medium	<i>Pentameris bachmannii</i>
Medium	<i>Pentameris pholiuroides</i>
Medium	<i>Ehrharta setacea</i> subsp. <i>uniflora</i>
Medium	<i>Anthospermum ericifolium</i>
Medium	Sensitive species 533
Medium	Sensitive species 878
Medium	<i>Geissorhiza bonaspei</i>
Medium	<i>Geissorhiza brehmii</i>
Medium	<i>Geissorhiza humilis</i>
Medium	<i>Ixia monadelpha</i>
Medium	Sensitive species 881
Medium	Sensitive species 683
Medium	Sensitive species 830
Medium	<i>Pauridia alba</i>
Medium	<i>Pauridia canaliculata</i>
Medium	<i>Pauridia pygmaea</i>
Medium	<i>Pseudalthenia aschersoniana</i>
Medium	<i>Oxalis natans</i>
Medium	<i>Erica capillaris</i> var. <i>capillaris</i>
Medium	<i>Stylapterus fruticosus</i>
Medium	<i>Hermannia procumbens</i> subsp. <i>procumbens</i>
Medium	<i>Sebaea rara</i>
Medium	Sensitive species 493
Medium	<i>Adenogramma rigida</i>
Medium	<i>Wachendorfia brachyandra</i>
Medium	<i>Hessea cinnamomea</i>
Medium	Sensitive species 497
Medium	<i>Isoetes capensis</i>
Medium	Sensitive species 133
Medium	<i>Isolepis inconspicua</i>
Medium	<i>Isolepis venustula</i>
Medium	<i>Trianoptiles solitaria</i>
Medium	<i>Ficinia elatior</i>
Medium	<i>Ficinia pinguior</i>
Medium	<i>Elegia prominens</i>
Medium	<i>Restio duthieae</i>
Medium	<i>Restio micans</i>
Medium	<i>Restio sabulosus</i>
Medium	<i>Restio impolitus</i>
Medium	<i>Restio papillosus</i>
Medium	<i>Restio pratensis</i>
Medium	<i>Cynanchum zeyheri</i>

Medium	Sensitive species 985
Medium	Sensitive species 120
Medium	Sensitive species 1139
Medium	<i>Acrolophia bolusii</i>
Medium	<i>Pterygodium cruciferum</i>
Medium	<i>Pterygodium microglossum</i>
Medium	<i>Heliophila promontorii</i>
Medium	<i>Gnidia spicata</i>
Medium	<i>Passerina paludosa</i>
Medium	<i>Lachnaea uniflora</i>
Medium	<i>Poecilolepis maritima</i>
Medium	<i>Steirodiscus tagetes</i>
Medium	<i>Senecio foeniculoides</i>
Medium	<i>Cotula eckloniana</i>
Medium	<i>Arctotis angustifolia</i>
Medium	<i>Arctotheca forbesiana</i>
Medium	<i>Cullumia squarrosa</i>
Medium	<i>Diosma dichotoma</i>
Medium	<i>Agathosma corymbosa</i>
Medium	<i>Agathosma glabrata</i>
Medium	<i>Adenandra villosa</i> subsp. <i>biseriata</i>
Medium	<i>Macrostylis villosa</i> subsp. <i>villosa</i>
Medium	<i>Cliffortia ericifolia</i>
Medium	<i>Cliffortia hirta</i>
Medium	<i>Limonium depauperatum</i>
Medium	<i>Muraltia brevicornu</i>
Medium	<i>Muraltia macropetala</i>
Medium	<i>Muraltia mitior</i>
Medium	Sensitive species 214
Medium	Sensitive species 158
Medium	Sensitive species 1265
Medium	<i>Wurmbea hiemalis</i>
Medium	<i>Wurmbea inusta</i>
Medium	<i>Phylica dioica</i>
Medium	<i>Phylica harveyi</i>
Medium	<i>Phylica plumosa</i> var. <i>squarrosa</i>
Medium	<i>Skiatophytum skiatophytoides</i>
Medium	<i>Lampranthus debilis</i>
Medium	<i>Lampranthus glaucus</i>
Medium	<i>Argyrobium velutinum</i>
Medium	<i>Xiphotheca reflexa</i>
Medium	<i>Psoralea alata</i>
Medium	<i>Aspalathus lebeckioides</i>
Medium	<i>Aspalathus tylodes</i>
Medium	<i>Leucospermum rodolentum</i>
Medium	<i>Protea scolymocephala</i>
Medium	Sensitive species 599
Medium	<i>Elegia verreauxii</i>
Medium	<i>Restio paludosus</i>
Medium	<i>Restio rigoratus</i>
Medium	Sensitive species 53
Medium	Sensitive species 654
Medium	<i>Lachnaea capitata</i>
Medium	<i>Lachnaea grandiflora</i>
Medium	<i>Cotula pusilla</i>

MAP OF RELATIVE TERRESTRIAL BIODIVERSITY THEME SENSITIVITY



Very High sensitivity	High sensitivity	Medium sensitivity	Low sensitivity
X			

Sensitivity Features:

Sensitivity	Feature(s)
Very High	Critically endangered ecosystem